

VERTICAL CROSS SECTION

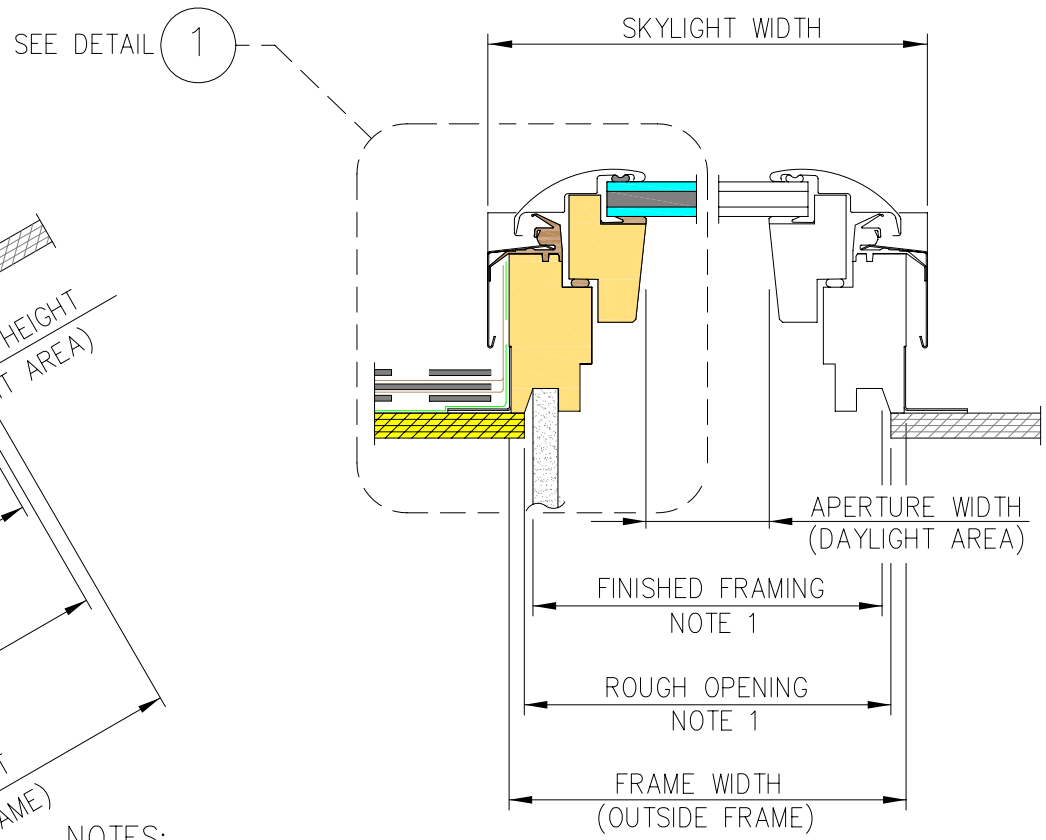

HORIZONTAL CROSS SECTION

NOTES:
 1. The ROUGH OPENING and FINISHED FRAMING dimensions are based on perpendicular interior finish material on all four sides and these dimensions will vary depending on the roof construction, the thickness and the design of the interior finish material.

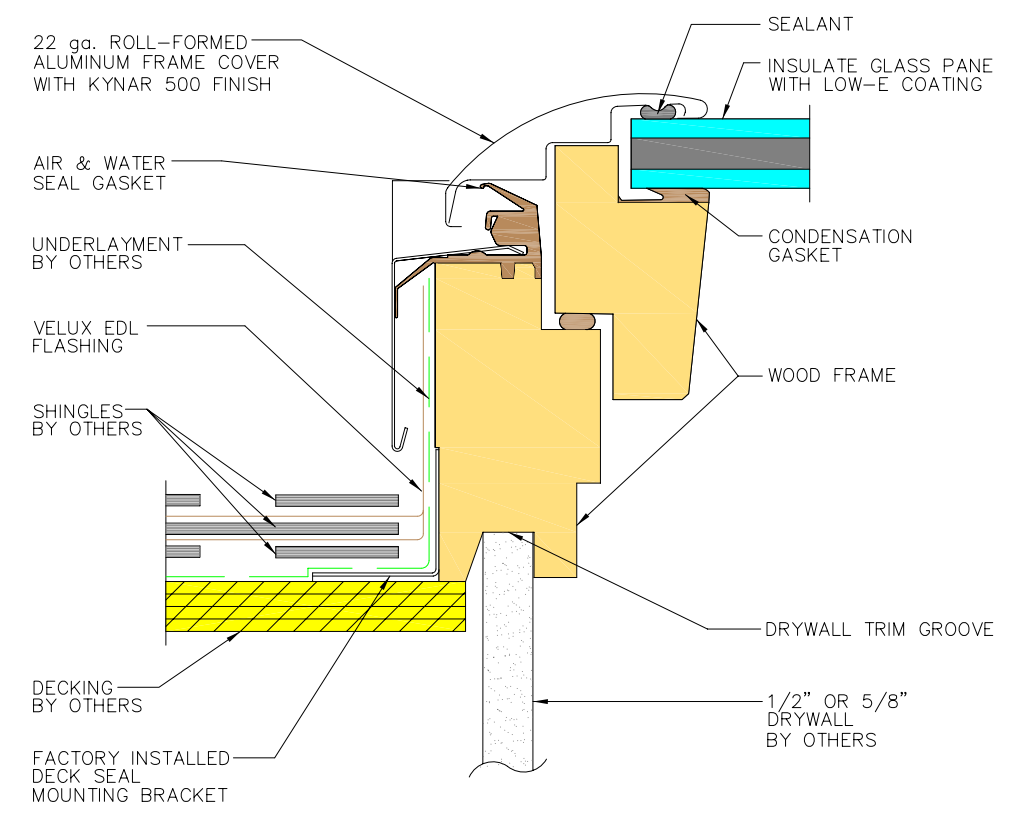

DETAIL 1

PRODUCT DIMENSIONS

METRIC UNITS (MILLIMETERS)								IMPERIAL UNITS (INCHES)							
SIZE	FRAME WIDTH	FRAME APERTURE WIDTH	SKYLIGHT WIDTH	FRAME HEIGHT	FRAME APERTURE HEIGHT	SKYLIGHT HEIGHT	DAYLIGHT AREA (SQ. M.)	SIZE	FRAME WIDTH	FRAME APERTURE WIDTH	SKYLIGHT WIDTH	FRAME HEIGHT	FRAME APERTURE HEIGHT	SKYLIGHT HEIGHT	DAYLIGHT AREA (SQ. FT.)
A06	387	248	407.7	1175	1036	1200	.25	A06	15 1/4	9 3/4	16 1/16	46 1/4	40 3/4	47 1/4	2.67
C01	546	407	566.7	695	556	720	.21	C01	21 1/2	16	22 5/16	27 3/8	21 7/8	28 3/8	2.27
C04	546	407	566.7	975	836	1000	.33	C04	21 1/2	16	22 5/16	38 3/8	32 15/16	39 3/8	3.50
C06	546	407	566.7	1175	1036	1200	.41	C06	21 1/2	16	22 5/16	46 1/4	40 3/4	47 1/4	4.38
C08	546	407	566.7	1395	1256	1420	.50	C08	21 1/2	16	22 5/16	54 15/16	49 1/2	55 15/16	5.34
M04	776	637	796.7	975	836	1000	.51	M04	30 9/16	25	31 3/8	38 3/8	32 15/16	39 3/8	5.48
M06	776	637	796.7	1175	1036	1200	.64	M06	30 9/16	25	31 3/8	46 1/4	40 3/4	47 1/4	6.86
M08	776	637	796.7	1395	1256	1420	.78	M08	30 9/16	25	31 3/8	54 15/16	49 1/2	55 15/16	8.36
S01	1136	997	1156.7	695	556	720	.52	S01	44 3/4	39 1/4	45 9/16	27 3/8	21 7/8	28 3/8	5.57
S06	1136	997	1156.7	1175	1036	1200	1.0	S06	44 3/4	39 1/4	45 9/16	46 1/4	40 3/4	47 1/4	10.73

<p>VELUX 1418 Evans Pond Road Greenwood, SC 29649 1-800-88-VELUX www.VELUXUSA.com</p> <p>Sky-Product Management</p>	Name JDH	Date Nov 08
	Checked by BDM	Dec 08
	Drawing No. VSE-01-1208	

VSE - Electric Venting Skylight
 Product Data, Product Dimensions,
 Cross Sections & Enlarged Detail

This drawing is an instrument of service and is provided for informational use only.